

Hand Switch

HR



Features

- ◆ HR is an embedded hand switch. There are two different versions available. One is standard version, which can work with Moteck standard control box, such as T Control, CBT2, CS1. And the other one is designed to connect with actuator directly, which makes up a simple system with a switching mode power supply and functions without control box.
- ◆ Main applications : homecare, furniture
- ◆ Max. number of motors this handset can drive : 1
- ◆ Available number of buttons : 2
- ◆ Housing appearance & color : Black
- ◆ Cable type and length : Straight cable 2000mm

Options

- ◆ Standard version : Work with Moteck P1 Communication version control box.
- ◆ Without control box version : Connect to actuator with a switching mode power supply directly and function without control box.
- ◆ 3000 mm straight cable

Compatibility

1. Control box

For standard Moteck P1 Communication version :

T Control, CBT2, CS1

(Remarks: Moteck F-type DIN plug is used.)



F-type plug

2. Actuator

For option of power version :

FD60, FD50, FD20, BD60, BDF60, BDN60, BD61, BD20

(Remarks: Special cable option of actuators to connect to HR hand switch directly as following diagram)

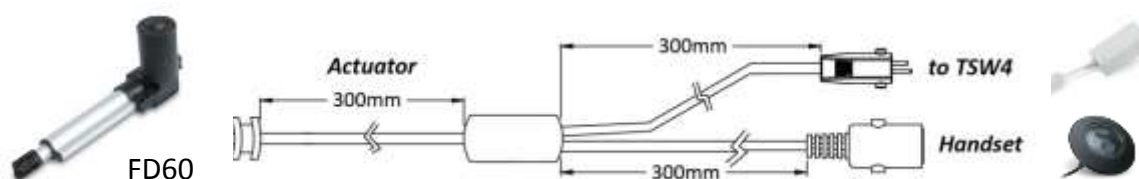

Dimensions

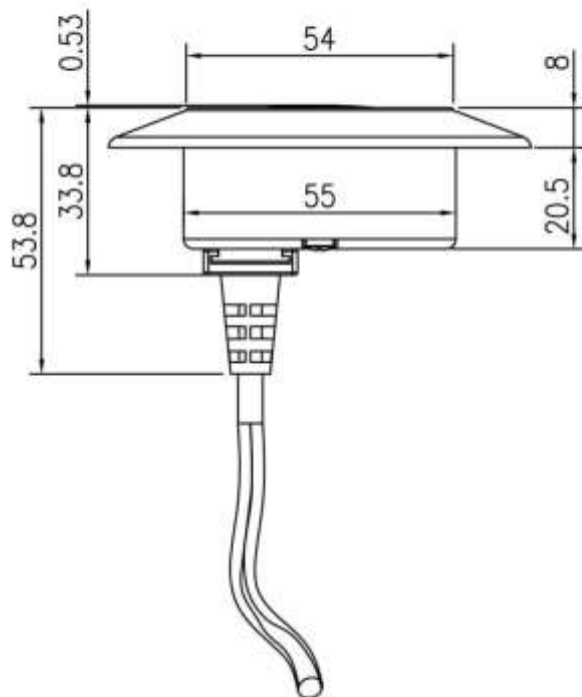
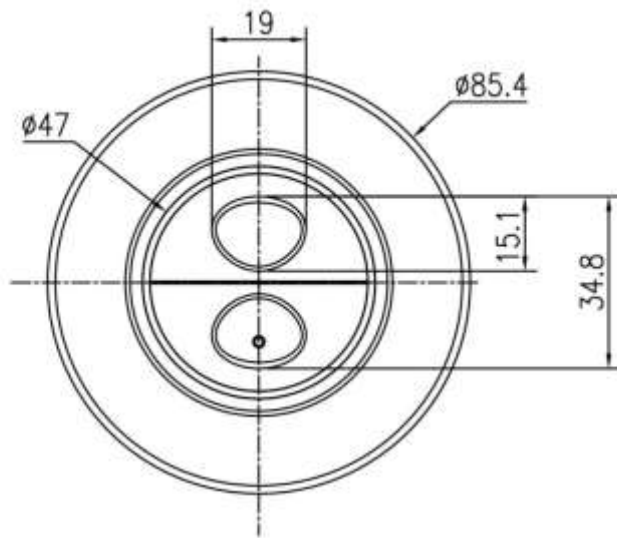

Unit: mm

Ordering Key

HR--

Version

0 : Standard version

P : Without control box version

Cable

2 : Straight (2000mm)

3 : Straight (3000mm)

Terms of Use

The user is responsible for determining the suitability of MOTECK products for specific applications. Due to continuous development in order to improve its products, MOTECK products are subject to frequent modifications and changes without prior notice. MOTECK reserves the right to discontinue the sale of any products displayed on its website or listed in its catalogue or other written materials drawn up by MOTECK.